

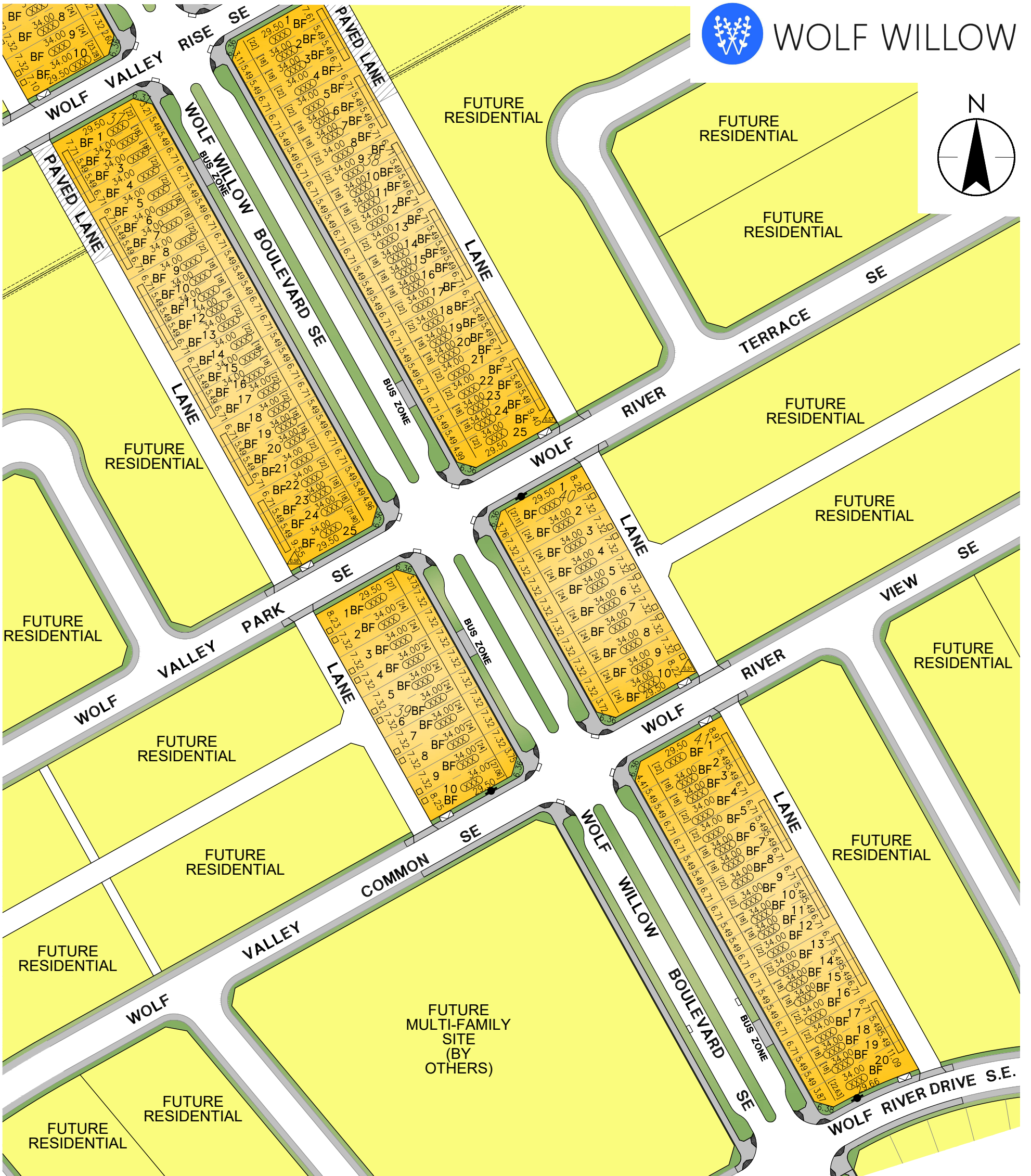

WOLF WILLOW

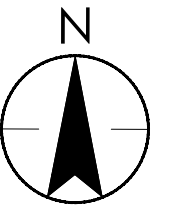

NTS

THIS PLAN IS A CONCEPT ONLY AND MAY BE SUBJECT TO CHANGE WITHOUT NOTICE

THE COPYRIGHTS TO ALL DESIGNS AND DRAWINGS ARE THE PROPERTY OF STANTEC CONSULTING LTD. REPRODUCTION OR USE FOR ANY PURPOSE OTHER THAN THAT AUTHORIZED BY STANTEC CONSULTING LTD. IS FORBIDDEN.



WESTCREEK

Legend

- L - LEVEL LOT
- BF - LEVEL LOT (BACK TO FRONT DRAINAGE)
- BFT - BACK TO FRONT TRANSITION LOT
- - SUGGESTED DRIVEWAY LOCATION
- - HYDRANT
- - CATCH BASIN
- ⊞ - COMMUNITY MAILBOX
- ⊞ - MUNICIPAL ADDRESS
- - CONCRETE DRAINAGE SWALE
- - - - MAINTENANCE ACCESS OR UTILITY RIGHT OF WAY (PRELIMINARY)
- ⊞ - WOOD SCREEN FENCE
- △ - MAX EAVES DIMENSION
- - FIXED STEEL BOLLARD

Client/Project

DAWES PIT LIMITED PARTNERSHIP
c/o WESTCREEK DEVELOPMENTS LTD.
WOLF WILLOW PHASE 8

PRELIMINARY

Title

Surface Information Plan

JUNE 09, 2023
116541108.142

NOTES:
FRONTAGES ARE APPROXIMATE ONLY. REFER TO LEGAL PLAN OF SUBDIVISION TO CONFIRM ALL LOT DIMENSIONS. REFER TO UTILITY RIGHTS OF WAY AND EASEMENT DOCUMENTS TO DETERMINE RESTRICTIONS ON EXTENT OF TITLE.

WARNING: SYMBOLS ARE SCHEMATIC ONLY AND NOT TO SCALE. SEE APPROVED DRAWINGS FOR EXACT LOCATIONS AND DIMENSIONS. THIS IS NOT A LEGAL PLAN. DIMENSIONS, SETBACK WIDTHS, AND LOCATIONS FOR ELECTRICAL, TELEPHONE AND CABLE TELEVISION PEDESTALS, STREET LIGHTS, AND MAILBOXES ARE COMPILED FROM AVAILABLE INFORMATION AND ARE SUBJECT TO CHANGE WITHOUT NOTICE. FOR VERIFICATION OF INFORMATION CALL (403)263-8111.

IN A LANELESS SUBDIVISION UTILITY PEDESTALS AND ELECTRIC TRANSFORMERS ARE TYPICALLY LOCATED IN THE FRONT OF THE LOT WITHIN A UTILITY RIGHT OF WAY. THE LOCATION OF THESE PEDESTALS AND TRANSFORMERS ARE BASED ON UTILITY REQUIREMENTS. IN A LANED SUBDIVISION, UTILITY PEDESTALS AND ELECTRIC TRANSFORMERS ARE TYPICALLY LOCATED IN A SIDEYARD POCKET EASEMENT (END OF BLOCK), IN A POCKET EASEMENT ON PRIVATE PROPERTY ADJACENT THE LANE (MID-BLOCKS), OR IN THE LANE COMPLETE WITH PROTECTIVE INFRASTRUCTURE SUCH AS BOLLARDS (MID-BLOCKS).

REFER TO APPROVED SHALLOW UTILITY PLANS FOR EXACT INFORMATION.

V:\116541108.dwg (116541108) (development_components) (marketing) (cadd) (41108.dwg)
2:44 PM 9 June 2023 - Shoma, C (shind)